

WIRE CABLE TRAYS

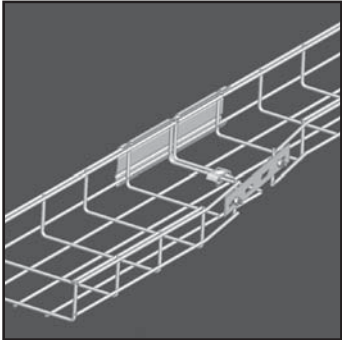

WIRE CABLE TRAYS

WIRE CABLE TRAYS

	Survey of the system	3-5
VFL		
VFL 35	Wire cable tray	3-6
VFL 60	Wire cable tray	3-7
VF		
VF 35	Wire cable tray heavy duty	3-8
VF 60	Wire cable tray heavy duty	3-9
VF 85	Wire cable tray heavy duty	3-10
VF 110	Wire cable tray heavy duty	3-11
COVER		
D	Universal cover	3-12
COVER CLAMPS		
DCLVF	Captive lid clamp VF/VFL	3-13
DCLVF 35	Captive lid clamp VF/VFL 35	3-13
ACCESSORIES		
VFO	Suspension piece for VF/VFL	3-14
VFM	Wall bracket for VF/VFL	3-14
VFMM	Wall and mounting bracket for VF/VFL	3-15
VFMM 35	Wall and mounting bracket for VF/VFL	3-15
VFCL	Fixation clips VF/VFL	3-15
VFCB	Central suspension bracket for VF/VFL	3-16
OBG	Upper bracket	3-16
VFVLB	Floor bracket for VF/VFL	3-17
VFVLBCL	Floor bracket clips for VF/VFL	3-17
VMB	Floor and wall bracket	3-18
SLOS	Division plate free	3-18
VFSLOSCL	Clips SLOS VF/VFL	3-19
MOUNTING PLATES		
VFK	Jointing clamp for VF/VFL	3-19
VFKG 30	Jointing clamp for VF/VFL	3-19
VFKK 25	Jointing clamp for VF/VFL	3-20
VFKS	Support joint for VF/VFL	3-20
KPVF	Snap-on joiner for VF/VFL	3-20
KPVFL 35	Snap quick-jointing plate for VFL 35	3-21
V 35*200	Jointing plate	3-21
TOOLS		
VFKNIP	Bolt cutter	3-21
	TECHNICAL INFORMATION	3-22

TECHNICAL INFORMATION

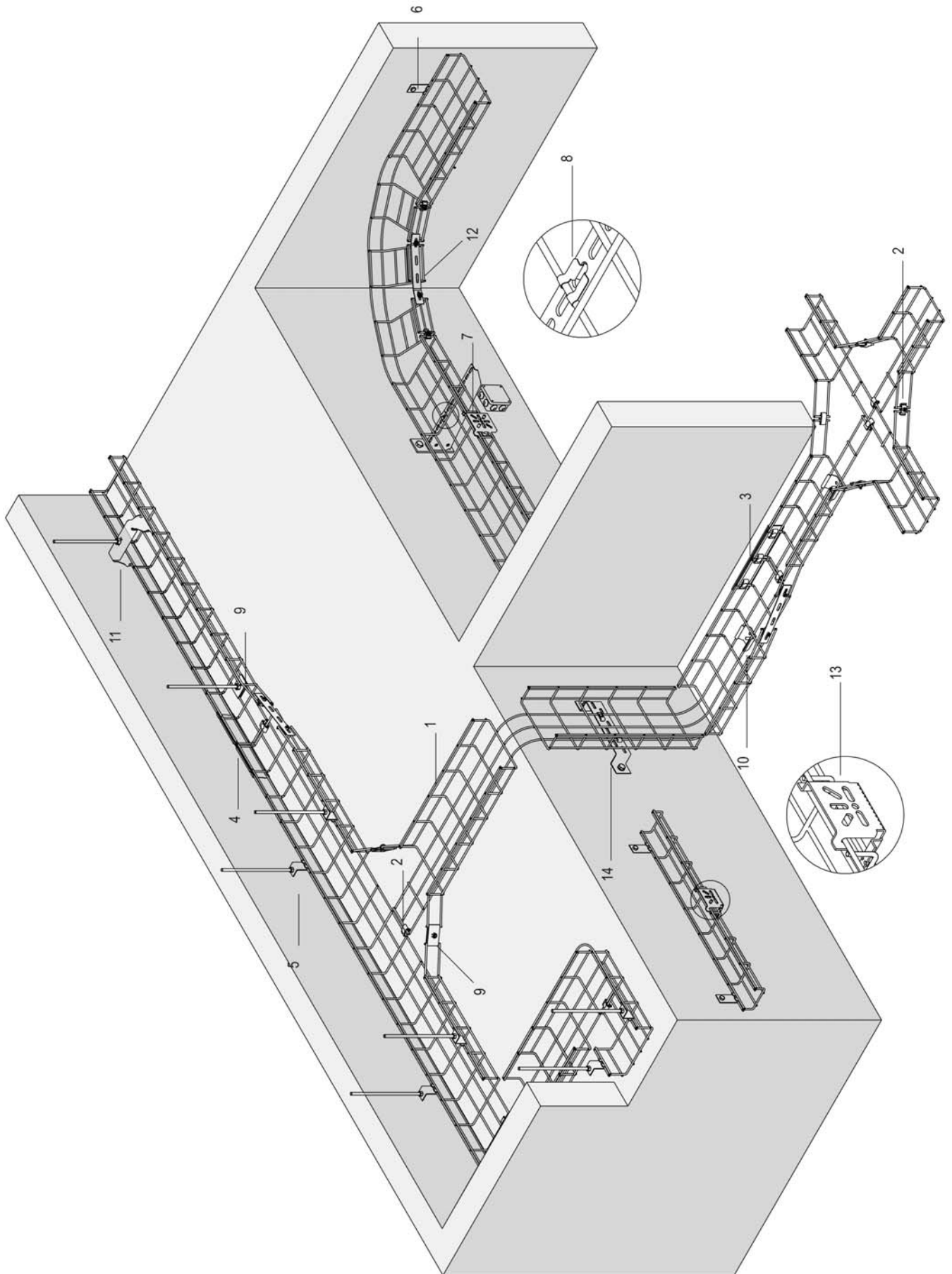

Survey of the system

	Description	Reference	Pag.
1	Wire cable tray heavy duty	VF 60	3-9
2	Jointing clamp for VF/VFL	VFK	3-19
3	Support joint for VF/VFL	VFKS	3-20
4	Snap-on joiner for VF/VFL	KPVF	3-20
5	Suspension piece for VF/VFL	VFO	3-14
6	Wall bracket for VF/VFL	VFM	3-14
7	Wall and mounting bracket for VF/VFL	VFMM	3-15
8	Fixation clips VF/VFL	VFCL	3-15
9	Central suspension bracket for VF/VFL	VFCB	3-16
10	Floor bracket for VF/VFL	VFVLB	3-17
11	Upper bracket	OBG	3-16
12	Jointing plate	V 35°200	3-21
13	Wall and mounting bracket for VF/VFL	VFMM 35	3-15
14	Floor and wall bracket	VMB	3-18

VFL 35

Wire cable tray

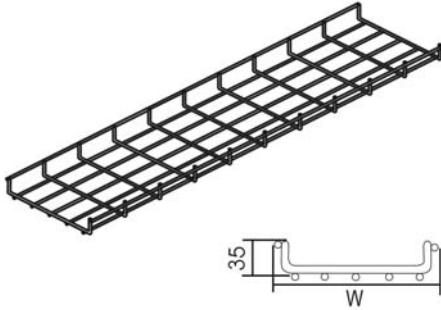

Screen : 50 x 100 mm
 Cross-wire : Ø 3.50 mm
 Alongside wire : Ø 5.00 mm

On Demand	Powder coating / Duplex System
Length	3000 mm
Standard finish	Electro zinc-plated
Optional finish 1	Hot-dip galvanised

1		Reference	Height	Width	Thickness	Length	kg/m	Packaging	Stock	Unit			
HD	-	VFL 30*065	30	65	-	3000	0,590	15	✓	m			
HD	-	VFL 35*100	35	100	-	3000	0,620	30	✓	m			
HD	-	VFL 35*150	35	150	-	3000	0,920	30	✓	m			
HD	-	VFL 35*200	35	200	-	3000	0,960	30	✓	m			
HD	-	VFL 35*250	35	250	-	3000	1,130	30	✓	m			
HD	-	VFL 35*350	35	350	-	3000	1,460	30	✓	m			
HD	-	VFL 35*450	35	450	-	3000	1,790	30	✓	m			
HD	-	VFL 35*550	35	550	-	3000	2,130	30	✓	m			

To fix with:

HD	-	KPVFL 35	35	-	-	-	0,100	30	✓	piece			
HD	-	VFK	-	-	-	-	0,020	100	✓	piece			

More technical specifications for this product can be found at the end of this chapter.

VFL 60

Wire cable tray

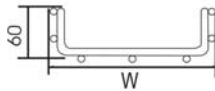
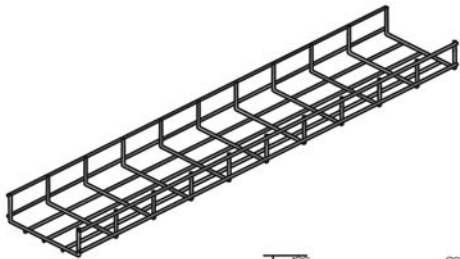

Screen : 50 x 100 mm
 Cross-wire : Ø 3.50 mm
 Alongside wire : Ø 5.00 mm

On Demand	Powder coating / Duplex System
Length	3000 mm
Standard finish	Electro zinc-plated
Optional finish 1	Hot-dip galvanised

1	Reference	Height	Width	Thickness	Length	kg/m	Packaging	Stock	Unit
HD	- VFL 60*050	60	50	-	3000	0,620	30	✓	m
HD	- VFL 60*100	60	100	-	3000	0,920	30	✓	m
HD	- VFL 60*150	60	150	-	3000	0,960	30	✓	m
HD	- VFL 60*200	60	200	-	3000	1,130	30	✓	m
HD	- VFL 60*300	60	300	-	3000	1,460	30	✓	m
HD	- VFL 60*400	60	400	-	3000	1,790	30	✓	m
HD	- VFL 60*500	60	500	-	3000	2,130	30	✓	m

To fix with:

HD	Reference	Height	Width	Thickness	Length	kg/m	Packaging	Stock	Unit
HD	- VFK	-	-	-	-	0,020	100	✓	piece
HD	- VFKS	60	-	-	-	0,270	10	✓	piece
HD	- KPVF	60	-	-	-	0,100	30	✓	piece

More technical specifications for this product can be found at the end of this chapter.

VF 35

Wire cable tray heavy duty

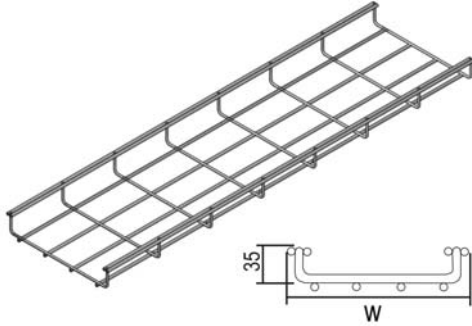

Screen : 50 x 100 mm
Thread : Ø 5 mm

On Demand	Powder coating / Duplex System
Length	3000 mm
Standard finish	Electro zinc-plated
Optional finish 1	Hot-dip galvanised

1	Reference	Height	Width	Thickness	Length	kg/m	Packaging	Stock	Unit
HD	- VF 35*100	35	100	-	3000	0,950	30	-	m
HD	- VF 35*150	35	150	-	3000	1,270	30	-	m
HD	- VF 35*200	35	200	-	3000	1,340	30	-	m
HD	- VF 35*250	35	250	-	3000	1,530	30	-	m
HD	- VF 35*350	35	350	-	3000	1,920	30	-	m
HD	- VF 35*450	35	450	-	3000	2,300	30	-	m
HD	- VF 35*550	35	550	-	3000	2,690	30	-	m

To fix with:

HD	Reference	Height	Width	Thickness	Length	kg/m	Packaging	Stock	Unit
HD	- VFK	-	-	-	-	0,020	100	✓	piece

More technical specifications for this product can be found at the end of this chapter.

VF 60

Wire cable tray heavy duty

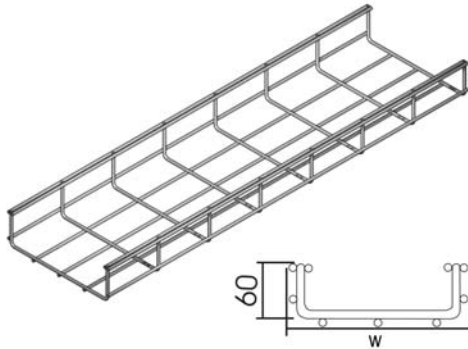

Screen : 50 x 100 mm
Thread : Ø 5 mm

On Demand	Powder coating / Duplex System
Length	3000 mm
Standard finish	Electro zinc-plated
Optional finish 1	Hot-dip galvanised

1	Reference	Height	Width	Thickness	Length	kg/m	Packaging	Stock	Unit			
HD	- VF 60*050	60	50	-	3000	0,950	30	✓	m			
HD	- VF 60*100	60	100	-	3000	1,270	30	✓	m			
HD	- VF 60*150	60	150	-	3000	1,340	20	✓	m			
HD	- VF 60*200	60	200	-	3000	1,530	30	✓	m			
HD	- VF 60*300	60	300	-	3000	1,920	30	✓	m			
HD	- VF 60*400	60	400	-	3000	2,300	30	✓	m			
HD	- VF 60*500	60	500	-	3000	2,690	30	✓	m			
HD	- VF 60*600	60	600	-	3000	3,080	30	✓	m			
To fix with:												
HD	- VFK	-	-	-	-	0,020	100	✓	piece			
HD	- VFKS	60	-	-	-	0,270	10	✓	piece			
HD	- KPVF	60	-	-	-	0,100	30	✓	piece			

More technical specifications for this product can be found at the end of this chapter.

VF 85

Wire cable tray heavy duty

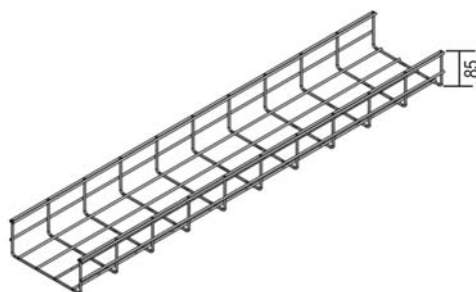

Screen : 50 x 100 mm
Thread : Ø 5 mm

On Demand	Powder coating / Duplex System
Length	3000 mm
Standard finish	Electro zinc-plated
Optional finish 1	Hot-dip galvanised

1		Reference	Height	Width	Thickness	Length	kg/m	Packaging	Stock	Unit			
HD	-	VF 85*100	85	100	-	3000	1,340	30	-	m			
HD	-	VF 85*150	85	150	-	3000	1,530	30	-	m			
HD	-	VF 85*250	85	250	-	3000	1,920	30	-	m			
HD	-	VF 85*350	85	350	-	3000	2,300	30	-	m			
HD	-	VF 85*450	85	450	-	3000	2,690	30	-	m			

To fix with:

HD	-	VFK	-	-	-	-	0,020	100	✓	piece			
----	---	-----	---	---	---	---	-------	-----	---	-------	--	--	--

More technical specifications for this product can be found at the end of this chapter.

VF 110

Wire cable tray heavy duty

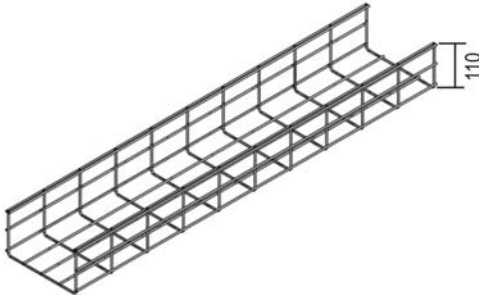

Screen : 50 x 100 mm
Thread : Ø 5 mm

On Demand	Powder coating / Duplex System
Length	3000 mm
Standard finish	Electro zinc-plated
Optional finish 1	Hot-dip galvanised

1	Reference	Height	Width	Thickness	Length	kg/m	Packaging	Stock	Unit			
HD	- VF 110*200	110	200	-	3000	1,920	30	-	m			
HD	- VF 110*300	110	300	-	3000	2,300	30	-	m			
HD	- VF 110*400	110	400	-	3000	2,690	30	-	m			
To fix with:												
HD	- VFK	-	-	-	-	0,020	100	✓	piece			

More technical specifications for this product can be found at the end of this chapter.

D

Universal cover

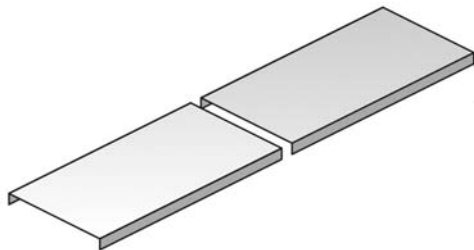

On Demand	Powder coating / Duplex System
Standard finish	Pre-galvanised
Optional finish 1	Hot-dip galvanised

1		Reference	Height	Width	Thickness	Length	kg/m	Packaging	Stock	Unit			
HD	-	D 050	-	50	-	3000	0,350	3	✓	m			
HD	-	D 075	-	75	-	2000	0,500	10	✓	m			
HD	-	D 100	-	100	-	2000	0,820	10	✓	m			
HD	-	D 150	-	150	-	2000	1,170	10	✓	m			
HD	-	D 200	-	200	-	2000	1,420	10	✓	m			
HD	-	D 250	-	250	-	2000	1,850	10	✓	m			
HD	-	D 300	-	300	-	2000	2,100	10	✓	m			
HD	-	D 400	-	400	-	2000	4,150	10	✓	m			
HD	-	D 500	-	500	-	2000	5,000	10	✓	m			
HD	-	D 600	-	600	-	2000	5,650	10	✓	m			

To fix with:													
-	-	DCLVF	-	-	-	-	0,005	100	✓	piece			
-	-	DCLVF 35	-	-	-	-	0,005	100	✓	piece			

- Especially used for horizontal en vertical sections.
- Cable tray cover with board height 10 mm.
- Covers with width > 400 mm are delivered with diagonal reinforcements.

Accessories

DCLVF

Captive lid clamp VF/VFL



For VFL 60, VF 60, VF 85 and VF 110

Standard finish

Stainless Steel

1	Reference	Height	Width	Thickness	Length	kg/piece	Packaging	Stock	Unit			
-	DCLVF	-	-	-	-	0,005	100	✓	piece			

More technical specifications for this product can be found at the end of this chapter.

DCLVF 35

Captive lid clamp VF/VFL 35



For VFL 35 and VF 35

Standard finish

Stainless Steel

1	Reference	Height	Width	Thickness	Length	kg/piece	Packaging	Stock	Unit			
-	DCLVF 35	-	-	-	-	0,005	100	✓	piece			

More technical specifications for this product can be found at the end of this chapter.

Do not use with : VFL 30*065.

VFO

Suspension piece for VF/VFL



On Demand	Powder coating / Duplex System
Standard finish	Pre-galvanised
Optional finish 1	Hot-dip galvanised

1		Reference	Height	Width	Thickness	Length	kg/piece	Packaging	Stock	Unit			
HD	-	VFO	-	-	-	-	0,030	48	✓	piece			

For threaded rod suspension M6/M8.
Threaded rod 'TIM 6' or 'TIM 8' should be ordered separately.

VFM

Wall bracket for VF/VFL

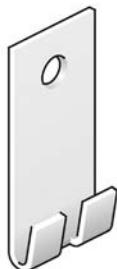

For fixation on the wall.

On Demand	Powder coating / Duplex System
Standard finish	Pre-galvanised
Optional finish 1	Hot-dip galvanised

1		Reference	Height	Width	Thickness	Length	kg/piece	Packaging	Stock	Unit			
HD	-	VFM	-	-	-	-	0,030	48	✓	piece			

Up to width 200 mm.

VFMM

Wall and mounting bracket for VF/VFL

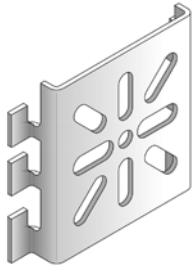

For VF 60 / VFL 60

On Demand	Powder coating / Duplex System
Standard finish	Pre-galvanised
Optional finish 1	Hot-dip galvanised

1		Reference	Height	Width	Thickness	Length	kg/piece	Packaging	Stock	Unit			
HD	-	VFMM	60	-	-	-	0,090	30	✓	piece			

More technical specifications for this product can be found at the end of this chapter.

VFMM 35

Wall and mounting bracket for VF/VFL

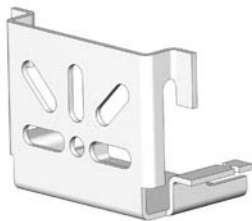

For VF 35 / VFL 35

On Demand	Powder coating / Duplex System
Standard finish	Pre-galvanised
Optional finish 1	Hot-dip galvanised

1		Reference	Height	Width	Thickness	Length	kg/piece	Packaging	Stock	Unit			
HD	-	VFMM 35	35	-	-	-	0,120	30	✓	piece			

VFCL

Fixation clips VF/VFL



For fixation of wire cable tray on the bracket.

Standard finish	Electro zinc-plated
-----------------	---------------------

1		Reference	Height	Width	Thickness	Length	kg/piece	Packaging	Stock	Unit			
-	-	VFCL	-	-	-	-	0,010	96	✓	piece			

VFCB

Central suspension bracket for VF/VFL



On Demand	Powder coating / Duplex System
Standard finish	Pre-galvanised
Optional finish 1	Hot-dip galvanised

1		Reference	Height	Width	Thickness	Length	kg/set	Packaging	Stock	Unit			
HD	-	VFCB	-	-	-	-	0,070	30	✓	set			

Per set (2 pieces)

Can be used for wire cable trays VFL/VF 35*100, VFL/VF 60*100 and VFL/VF 60*150.

For threaded rod suspension M6/M8.

Threaded rod TIM 6 or TIM 8 and nut M 6 or M 8 should be ordered separately.

OBG

Upper bracket

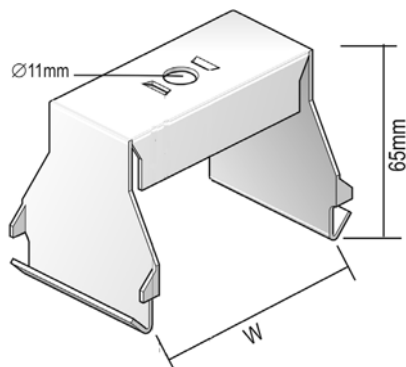

To mount cable trays with partition.

Width	Max. load (in daN)
050	200
075	200
100	200
150	200
200	200
250	150
300	150
400	90

On Demand	Powder coating / Duplex System
Standard finish	Pre-galvanised
Optional finish 1	Hot-dip galvanised

1		Reference	Height	Width	Thickness	Length	kg/piece	Packaging	Stock	Unit			
HD	-	OBG 050	-	50	-	-	0,100	12	✓	piece			
HD	-	OBG 075	-	75	-	-	0,130	12	✓	piece			
HD	-	OBG 100	-	100	-	-	0,140	12	✓	piece			
HD	-	OBG 150	-	150	-	-	0,190	12	✓	piece			
HD	-	OBG 200	-	200	-	-	0,220	12	✓	piece			
HD	-	OBG 250	-	250	-	-	0,270	12	✓	piece			
HD	-	OBG 300	-	300	-	-	0,310	6	✓	piece			
HD	-	OBG 400	-	400	-	-	0,390	6	✓	piece			

To be mounted with threaded rod TIM 8 or TIM 10.

Accessories

VFVLB

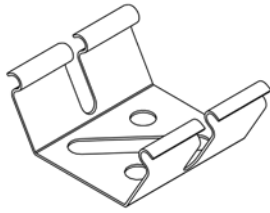
Floor bracket for VF/VFL

		Standard finish						Electro zinc-plated					
1		Reference	Height	Width	Thickness	Length	kg/piece	Packaging	Stock	Unit			
-	-	VFVLB	-	-	-	-	0,030	30	✓	piece			

Up to width 250 mm, minimum 2 pieces per meter.
As from width 300 mm, minimum 4 pieces per meter.

VFVLBCL

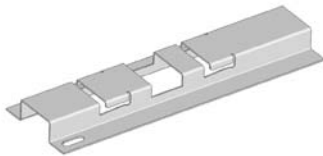
Floor bracket clips for VF/VFL

		Standard finish						Pre-galvanised					
1		Reference	Height	Width	Thickness	Length	kg/piece	Packaging	Stock	Unit			
-	-	VFVLBCL 150	20	150	-	-	0,210	30	✓	piece			
-	-	VFVLBCL 200	20	200	-	-	0,260	30	✓	piece			
-	-	VFVLBCL 300	20	300	-	-	0,360	30	✓	piece			
-	-	VFVLBCL 400	20	400	-	-	0,470	30	✓	piece			
-	-	VFVLBCL 500	20	500	-	-	0,570	30	✓	piece			
-	-	VFVLBCL 600	20	600	-	-	0,670	30	✓	piece			

To use with :

VFVLBCL 150 : VF/VFL 35*100, VF/VFL 60*100, VF/VFL 60*150

VFVLBCL 200 : VF/VFL 60*200

VFVLBCL 300 : VF/VFL 35*250, VF/VFL 60*300

VFVLBCL 400 : VF/VFL 35*350, VF/VFL 60*400

VFVLBCL 500 : VF/VFL 35*450, VF/VFL 60*500

VFVLBCL 600 : VF/VFL 35*550, VF/VFL 60*600

VMB

Floor and wall bracket

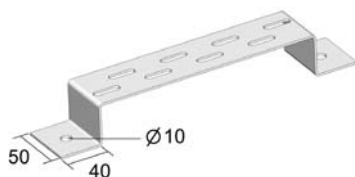

Suitable as floor-, wall-, and suspension bracket.

On Demand	Powder coating / Duplex System
Max. load	200 daN
Standard finish	Pre-galvanised
Optional finish 1	Hot-dip galvanised

1	Reference	Height	Width	Thickness	Length	kg/piece	Packaging	Stock	Unit
HD	- VMB 100	40	100	2,00	-	0,190	30	✓	piece
HD	- VMB 150	40	150	2,00	-	0,220	30	✓	piece
HD	- VMB 200	40	200	2,00	-	0,260	30	✓	piece
HD	- VMB 300	40	300	2,00	-	0,330	30	✓	piece
HD	- VMB 400	40	400	2,00	-	0,390	30	✓	piece
HD	- VMB 500	40	500	2,00	-	0,460	30	✓	piece
HD	- VMB 600	40	600	2,00	-	0,530	30	✓	piece

More technical specifications for this product can be found at the end of this chapter.

Floor bracket and suspension bracket : to mount with VFCL.

Wall bracket : to mount with VFK

SLOS

Division plate free

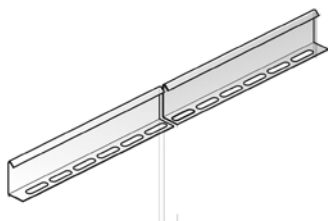

On Demand	Powder coating / Duplex System
Standard finish	Pre-galvanised
Optional finish 1	Hot-dip galvanised

1	Reference	Height	Width	Thickness	Length	kg/m	Packaging	Stock	Unit
HD	- SLOS 35	35	-	-	3000	0,330	150	✓	m
HD	- SLOS 60	60	-	-	3000	0,510	120	✓	m
HD	- SLOS 85	85	-	-	3000	0,680	60	✓	m
HD	- SLOS 110	110	-	-	3000	0,820	3	✓	m

To fix with:									
HD	- VFK	-	-	-	-	0,020	100	✓	piece
-	- VFSLOSCL	-	-	-	-	0,003	10	✓	piece

More technical specifications for this product can be found at the end of this chapter.

Fixation set : 1 per meter.

Accessories

VFSLOSCL

Clips SLOS VF/VFL

Standard finish

Spring steel

1	Reference	Height	Width	Thickness	Length	kg/piece	Packaging	Stock	Unit			
-	VFSLOSCL	-	-	-	-	0,003	10	✓	piece			

VFK

Jointing clamp for VF/VFL

On Demand

Powder coating / Duplex System

Standard finish

Pre-galvanised

Optional finish 1

Hot-dip galvanised

1	Reference	Height	Width	Thickness	Length	kg/piece	Packaging	Stock	Unit			
HD	VFK	-	-	-	-	0,020	100	✓	piece			

Bolt RBK 6*20 and nut RM 6 inclusive.

VFKG 30

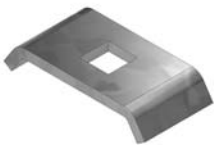
Jointing clamp for VF/VFL

On Demand

Powder coating / Duplex System

Standard finish

Pre-galvanised

Optional finish 1

Hot-dip galvanised

1	Reference	Height	Width	Thickness	Length	kg/piece	Packaging	Stock	Unit			
HD	VFKG 30	-	-	-	-	0,020	200	✓	piece			

VFKK 25

Jointing clamp for VF/VFL

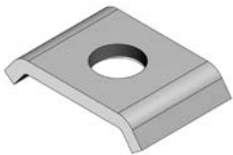

On Demand	Powder coating / Duplex System
Standard finish	Pre-galvanised
Optional finish 1	Hot-dip galvanised

1		Reference	Height	Width	Thickness	Length	kg/piece	Packaging	Stock	Unit			
HD	-	VFKK 25	-	-	-	-	0,020	200	✓	piece			

VFKS

Support joint for VF/VFL



For maximum stability and safety. Can only be used with VF 60 / VFL 60.

On Demand	Powder coating / Duplex System
Standard finish	Pre-galvanised
Optional finish 1	Hot-dip galvanised

1		Reference	Height	Width	Thickness	Length	kg/piece	Packaging	Stock	Unit			
HD	-	VFKS	60	-	-	-	0,270	10	✓	piece			

3x bolt RBK 6*20, 3x nut RM 6 and 3x VFKG 30 inclusive.

KPVF

Snap-on joiner for VF/VFL

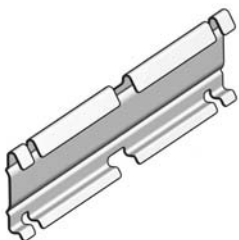

For a quick jointing without bolts and nuts. Can only be used with VFL 60 and VF 60.

On Demand	Powder coating / Duplex System
Standard finish	Pre-galvanised
Optional finish 1	Hot-dip galvanised

1		Reference	Height	Width	Thickness	Length	kg/piece	Packaging	Stock	Unit			
HD	-	KPVF	60	-	-	-	0,100	30	✓	piece			

Accessories

KPVFL 35

Snap quick-jointing plate for VFL 35



For screwless connection of VFL 35.

On Demand	Powder coating / Duplex System
Standard finish	Pre-galvanised
Optional finish 1	Hot-dip galvanised

1		Reference	Height	Width	Thickness	Length	kg/piece	Packaging	Stock	Unit			
HD	-	KPVFL 35	35	-	-	-	0,100	30	✓	piece			

Do not use with VFL 30*065.

V 35*200

Jointing plate

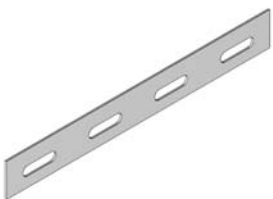

On Demand	Powder coating / Duplex System
Standard finish	Pre-galvanised
Optional finish 1	Hot-dip galvanised

1		Reference	Height	Width	Thickness	Length	kg/piece	Packaging	Stock	Unit			
HD	-	V 35*200	35	200	-	-	0,040	48	✓	piece			

VFKNIP

Bolt cutter



Bolt cutter with offset cut

Standard finish

1		Reference	Height	Width	Thickness	Length	kg/piece	Packaging	Stock	Unit			
-	-	VFKNIP	-	-	-	-	0,750	1	✓	piece			

- facilitates cutting and processing of basket trays.
- provided with jaws with offset cut
- ideal for making bends, T-pieces and other accessoires.
- Always cut as close as possible to the crossing.

VFL 35

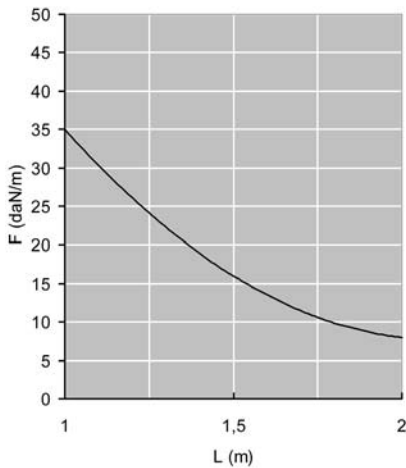

LOAD DIAGRAM

Graph valid for VFL 35. This diagram illustrates the permissible uniformly distributed loads applied to multiple supports. They comply with IEC 61537 par 10.3.3 test type III with connection to 1/5 of the span.

F = max. admissible load (daN/m)
L = support distance (m)

Max. deflection (m) = L/100

VFL 60

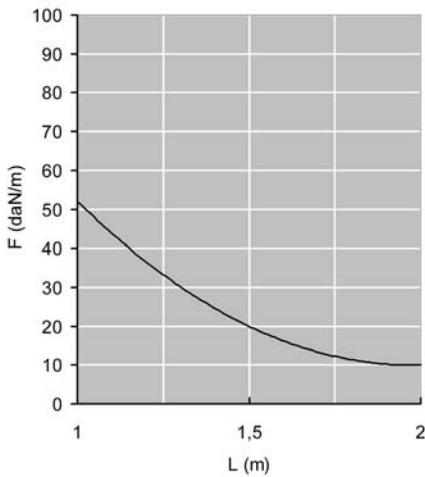

LOAD DIAGRAM

Graph valid for VFL 60. This diagram illustrates the permissible uniformly distributed loads applied to multiple supports. They comply with IEC 61537 par 10.3.3 test type III with connection to 1/5 of the span.

F = max. admissible load (daN/m)
L = support distance (m)

Max. deflection (m) = L/100

VF 35

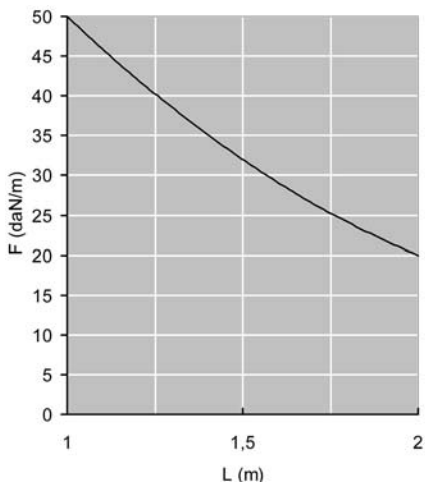

LOAD DIAGRAM

Graph valid for VF 35. This diagram illustrates the permissible uniformly distributed loads applied to multiple supports. They comply with IEC 61537 par 10.3.3 test type III with connection to 1/5 of the span.

F = max. admissible load (daN/m)
L = support distance (m)

Max. deflection (m) = L/100

VF 60

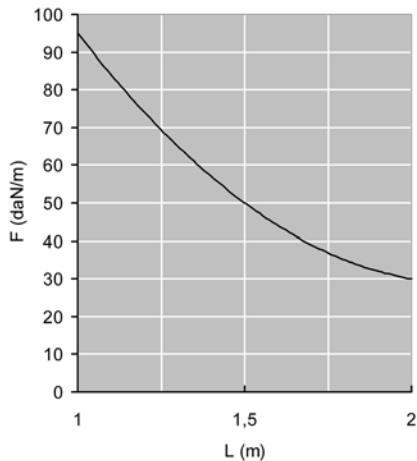

LOAD DIAGRAM

Graph valid for VF 60. This diagram illustrates the permissible uniformly distributed loads applied to multiple supports. They comply with IEC 61537 par 10.3.3 test type III with connection to 1/5 of the span.

F = max. admissible load (daN/m)
L = support distance (m)

Max. deflection (m) = L/100

VF 85

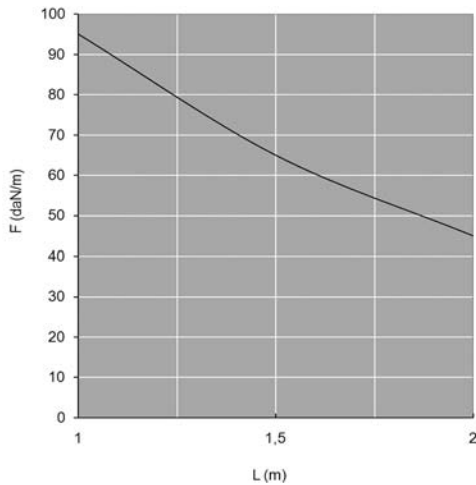

LOAD DIAGRAM

Graph valid for VF 85. This diagram illustrates the permissible uniformly distributed loads applied to multiple supports. They comply with IEC 61537 par 10.3.3 test type III with connection to 1/5 of the span.

F = max. admissible load (daN/m)
L = support distance (m)

Max. deflection (m) = L/100

VF 110

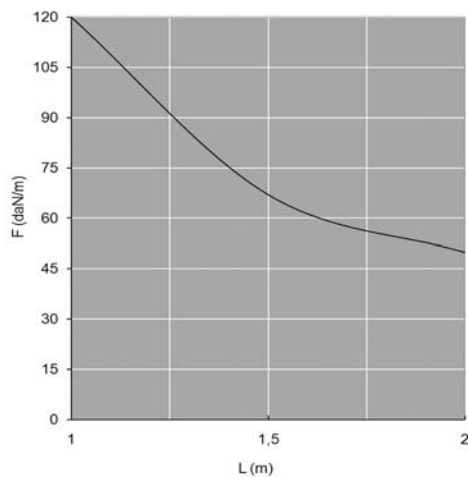

LOAD DIAGRAM

Graph valid for VF 110. This diagram illustrates the permissible uniformly distributed loads applied to multiple supports. They comply with IEC 61537 par 10.3.3 test type III with connection to 1/5 of the span.

F = max. admissible load (daN/m)
L = support distance (m)

Max. deflection (m) = L/100

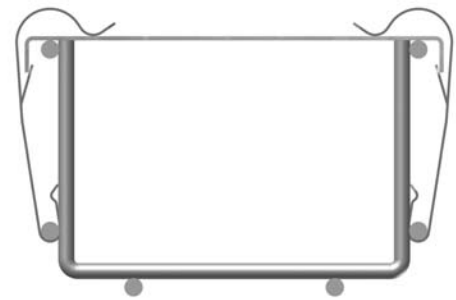
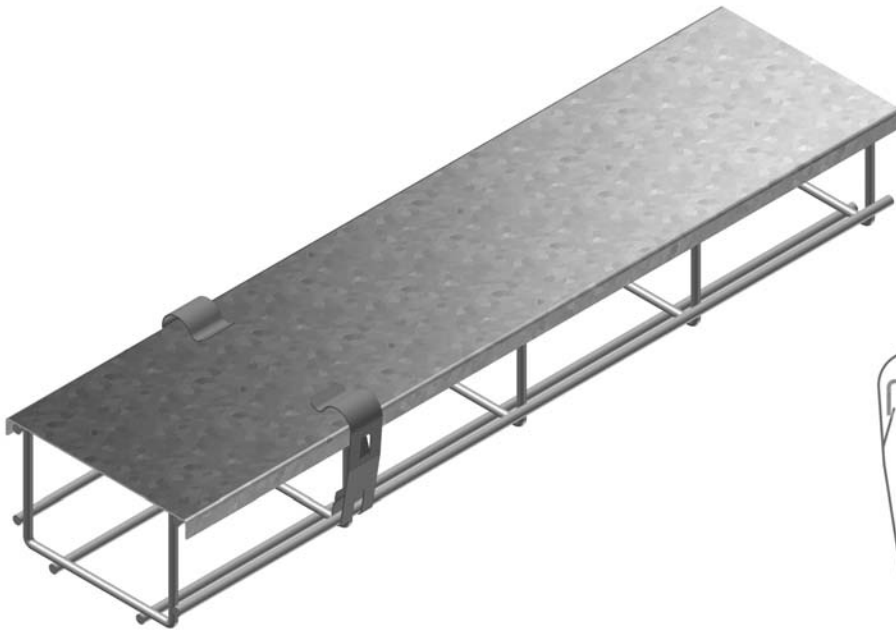
DCLVF**Mounting principle**

DCLVF 35

Mounting principle

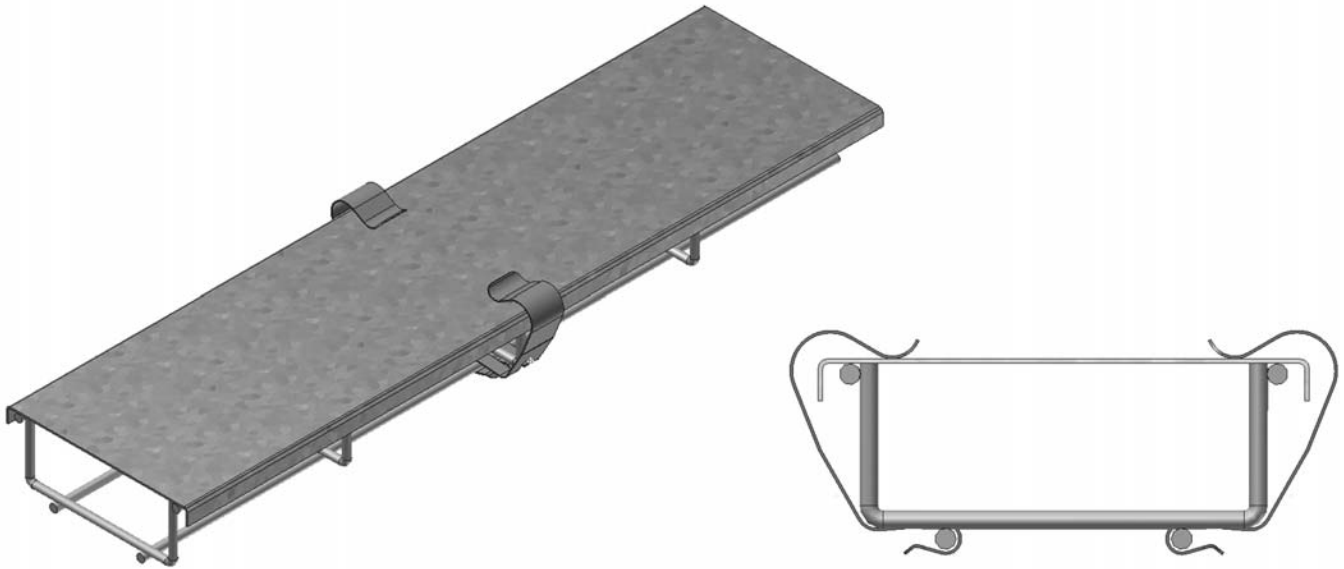

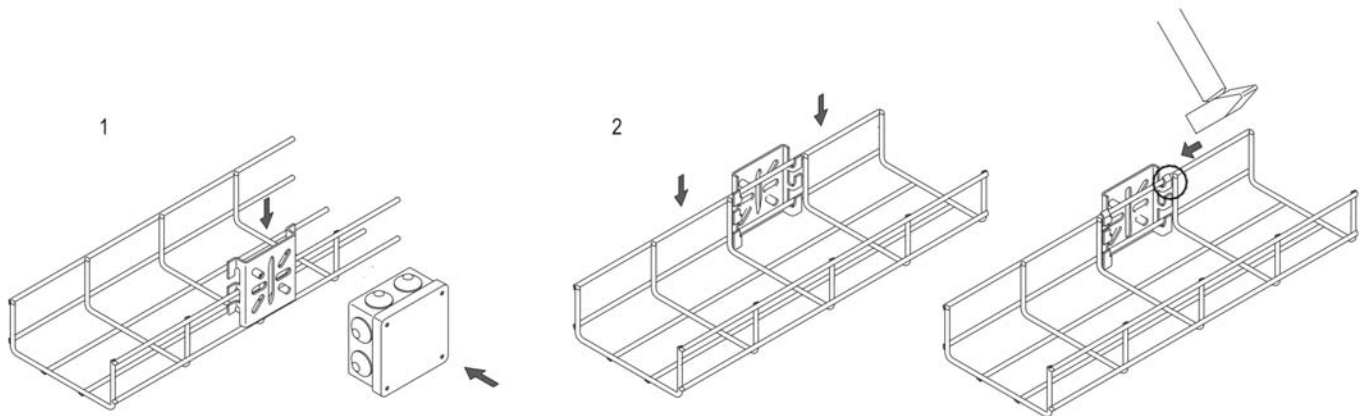
VFMM**Mounting principle**

For fixation of contact boxes and wall fixation.
Can only be used with VFL 60 and VF 60.

VMB

Mounting principle

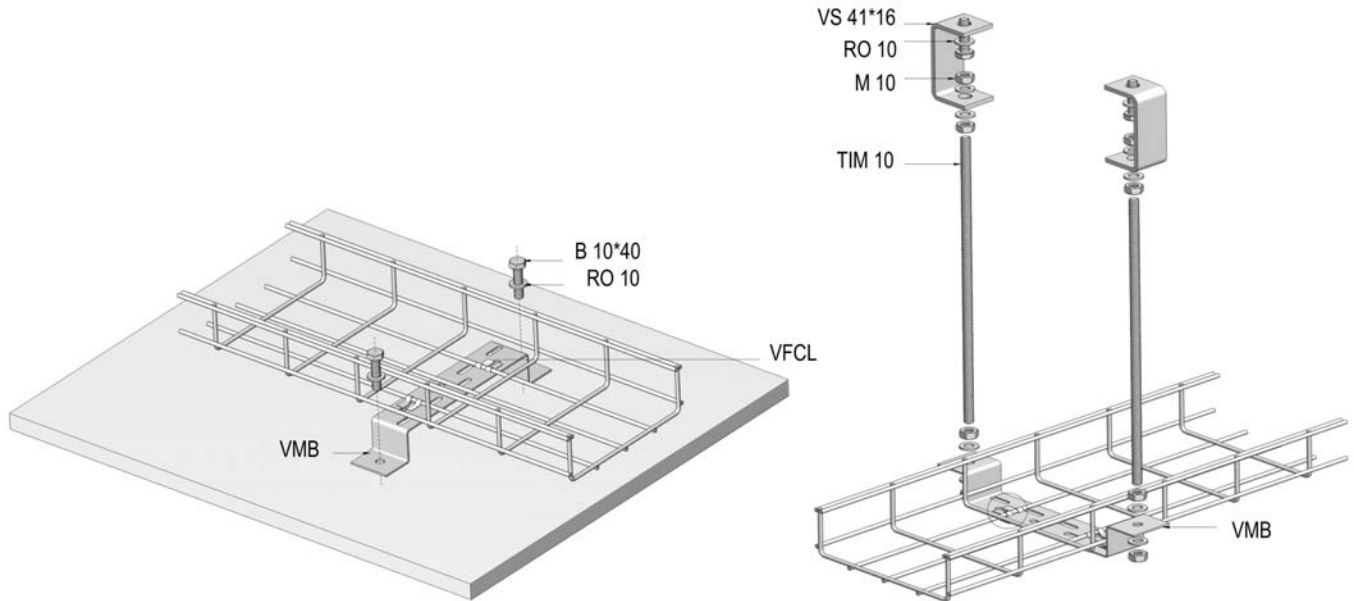

SLOS

Mounting principle

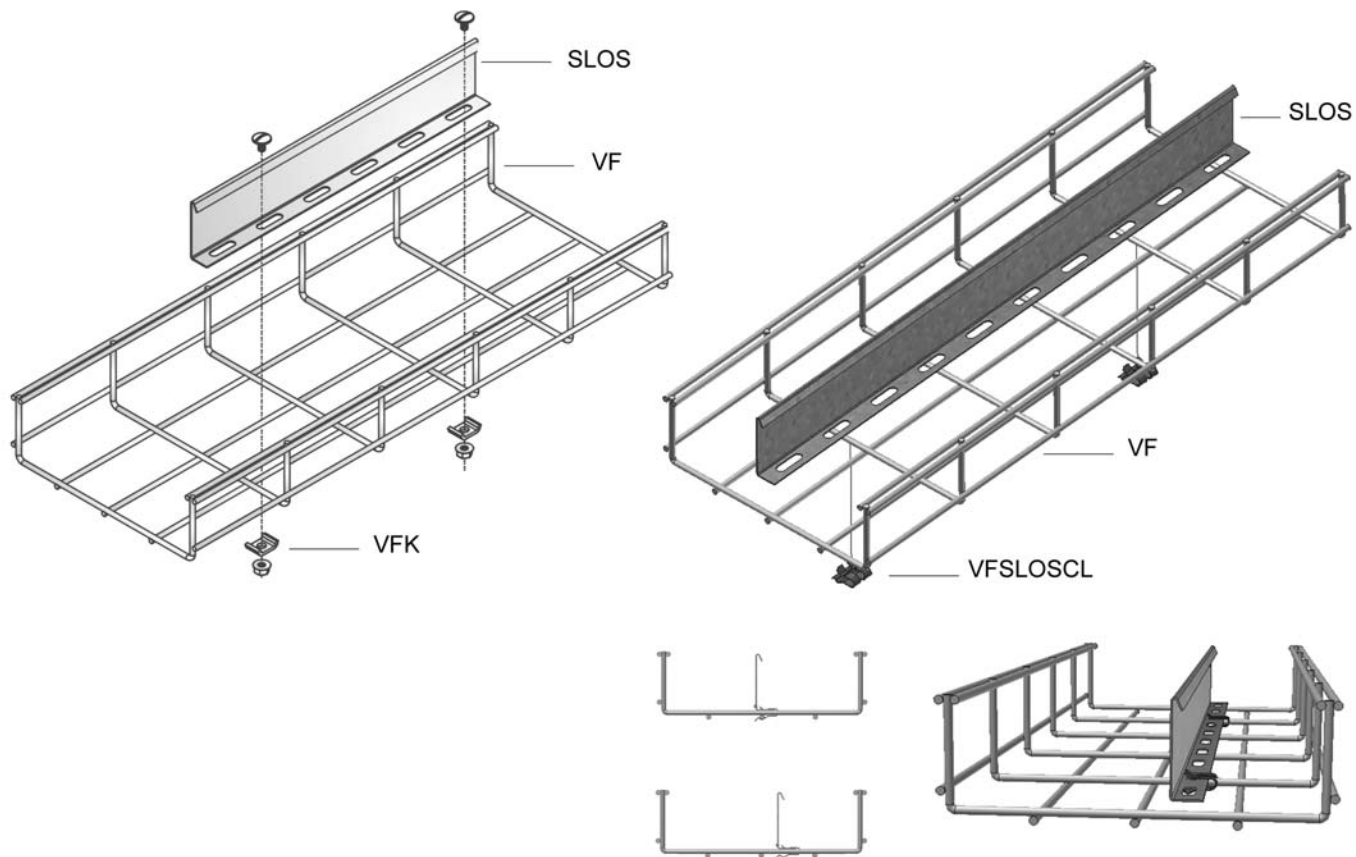

HOW TO CUT THE WIRE

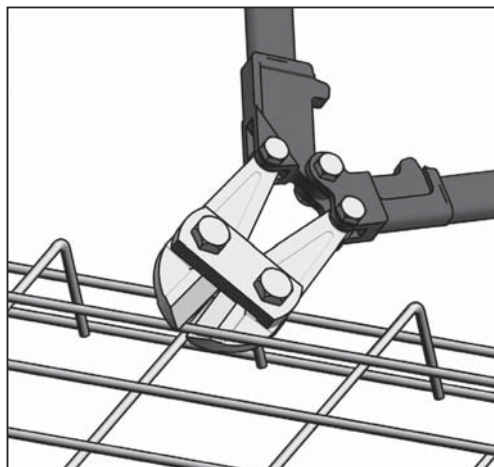

The shape of the cable basket can be changed to your requirements. For cutting of the wire mesh, we recommend the use of a professional set of cutting pliers with offset cut (drawing here below).
The cutting of the wire is by preference being done as close as possible to the crossing of the wires, in order to prevent cable damage.

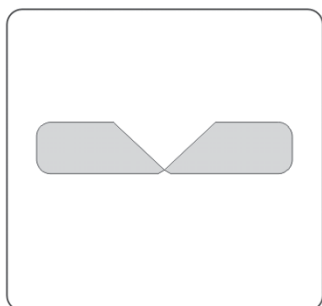

yes
Offset cut

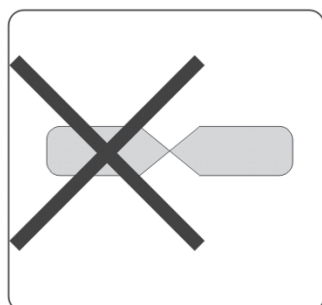

no
Central cut

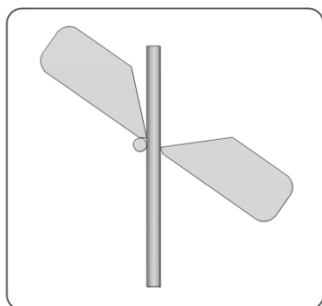

Placing of the clamping jaws

BEND WITH LARGE RADIUS

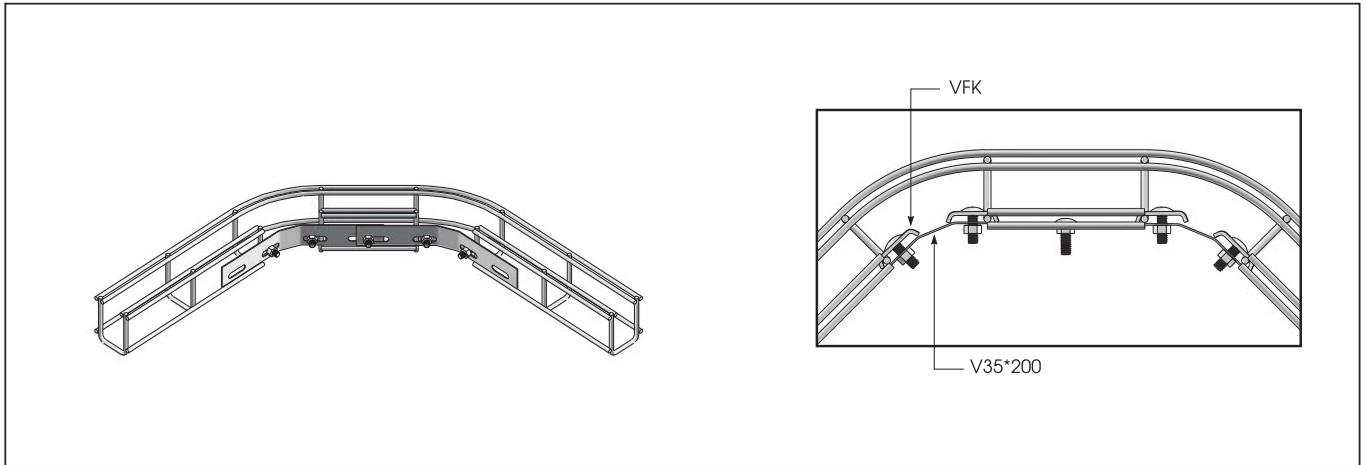

Widths 100 - 550

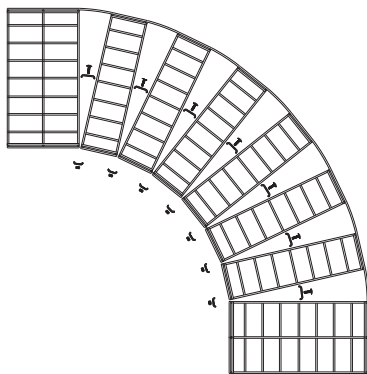
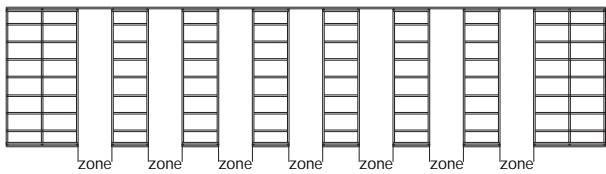
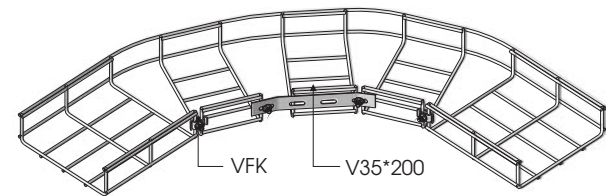

Width	Height	Zones	VFK	VFCB	V 35*200
100	35/60	3	2	2	1
150	35/60	3	4	-	1
200	35/60	4	4	-	1
250	35	5	6	-	1
300	60	5	5	-	-
350	35	6	6	-	-
400	60	7	7	-	-
450	35	8	8	-	-
500	60	9	9	-	-
550	35	10	10	-	-

Fixation possibilities

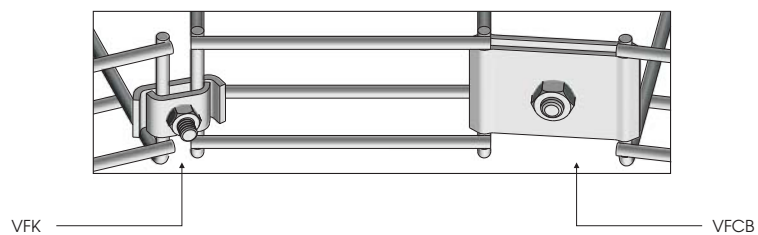

BEND WITH SMALL RADIUS

Method A

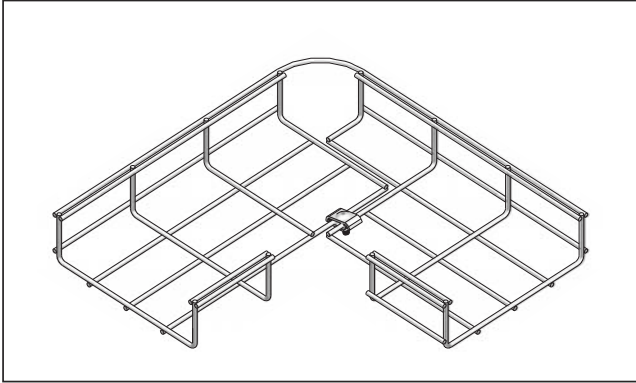

Method B

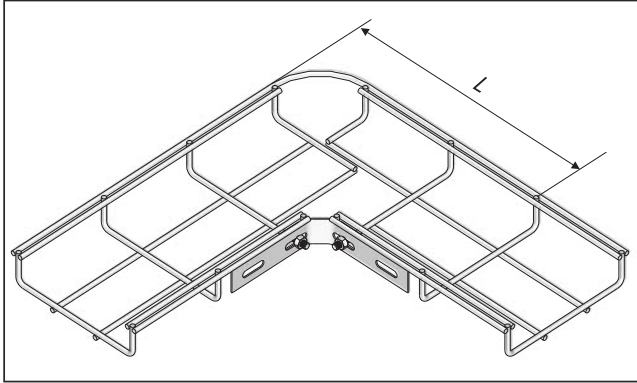

Width	Height	VFK	V 35*200	Zones	Mounted	Method	Lenght
100	35/60	2	1			B	269,5
150	35	2	1			B	269,5
150	60	2	1			B	269,5
200	35	1	0			B	369,5
200	60	1	0			A	369,5
250	35	2	1			B	369,5
300	60	2	0			A	469,5
350	35	2	1			B	469,5
400	60	2	0			A	569,5
450	35	2	1			B	569,5
500	60	3	0			A	669,5
550	35	2	1			B	669,5
600	60	4	0			A	679,5

To make a small radius bend, one has to take a length of cable basket and cut away the necessary zones out of the bottom and the side. Then bend the cable basket to an angle of 90° and connect both ends by means of method A or B as mentioned in the table above. For the cable basket, width 50, only a large radius can be made.

T-PIECE

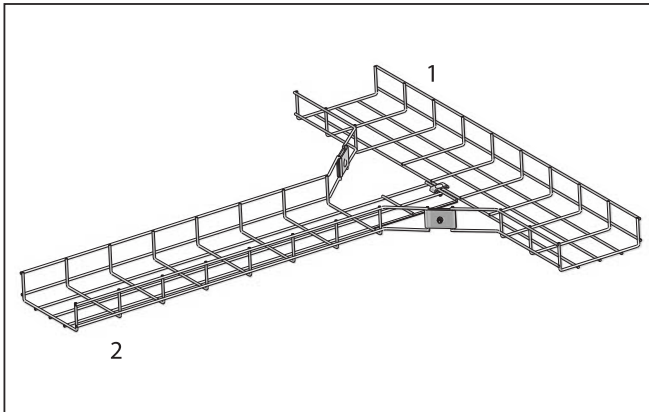

Cable basket 1:

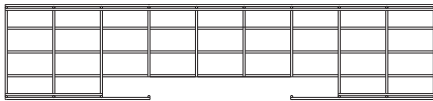

Cable basket 2:

Equal for all widths

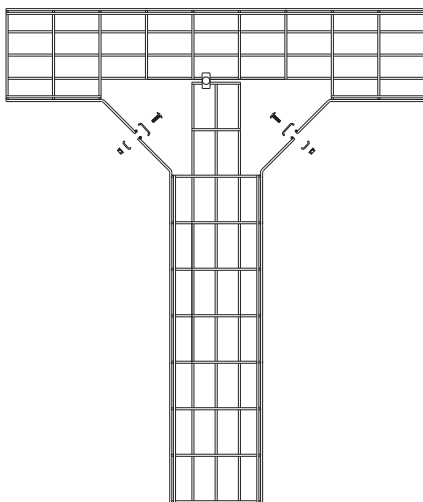
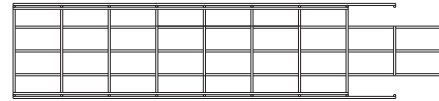

Width cable basket 2	Number of zones to cut away	
	Bottom	Side
50	-	-
100	4	2
150	4	2
200	5	3
250	5	3
300	6	4
350	6	4
400	7	5
450	7	5
500	8	6
550	8	6

A T-piece is being made by cutting away the side of cable basket 1, according to the data mentioned in the table above. The amount of zones need to be cut away in cable basket 2, always remain the same. The remaining sides are being bend across each other. The cable basket are being connected by the use of VFCB or VFK.

CROSS SECTION

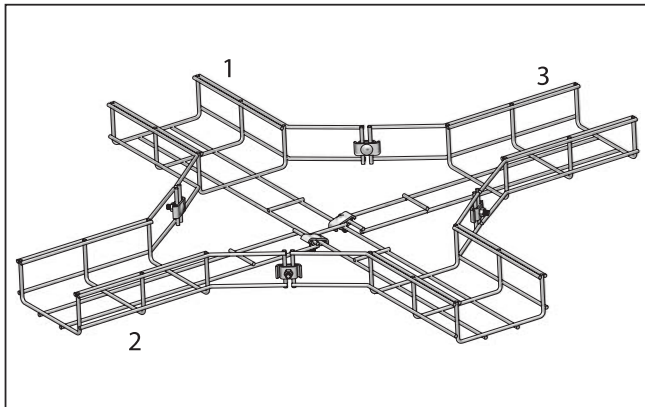

Cable basket 1:

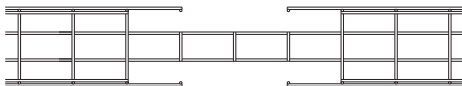

Cable basket 2, 3:

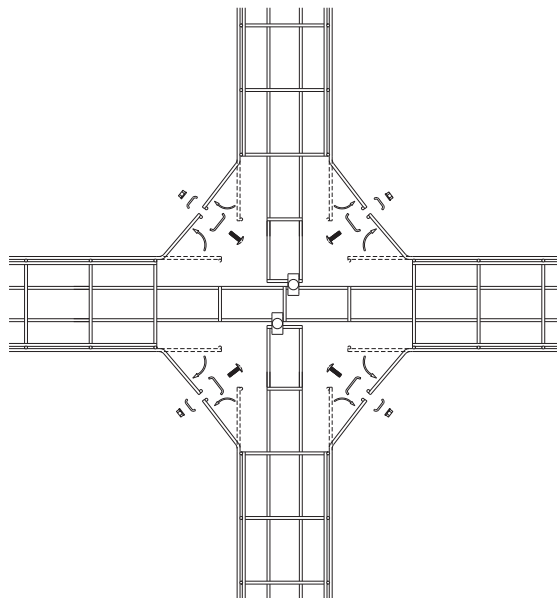
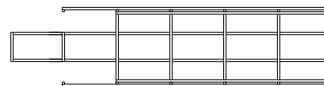

A cross section is being made by the same principle then a T-piece

1. Take a length of the required cable basket and cut away the side and bottom, according to the data.
2. Cut away the bottom from cable basket 2 and 3, by the same principle then for the second cable basket for the making of a T-piece
3. Bend the sides across each other.
4. Connect all the ends by means of VFK, VFCB or V35*200.

REDUCER

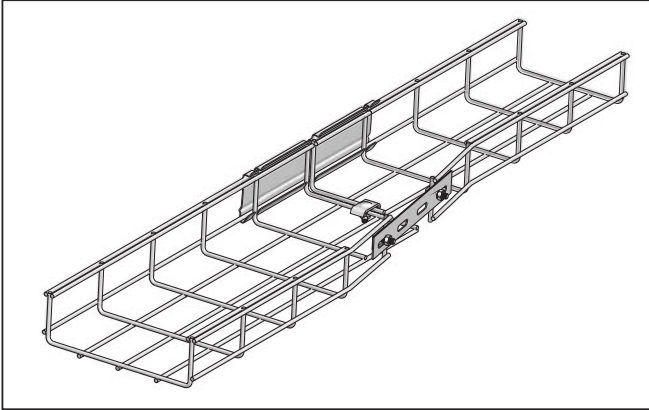

Cable basket can be reduced in order to connect them to a smaller section. All combinations are being based upon a few basic principles in order to obtain the required result.

1. Cut away the required zones from the bottom and the side.
2. Bend the side to the required width.
3. Connect the ends by means of KPVF, VFK and V 35*200

Difference of 50mm

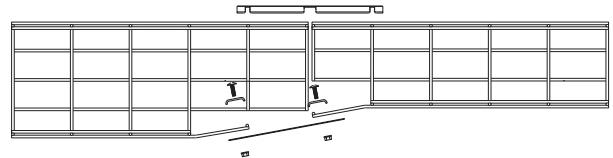
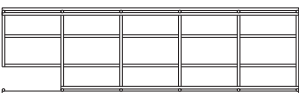
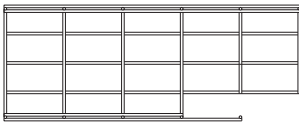

Difference of 100mm

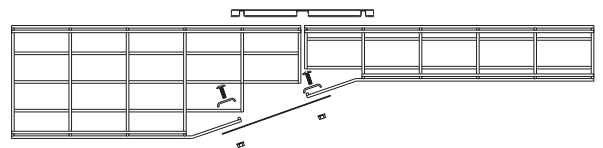
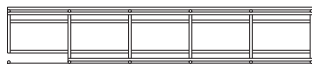
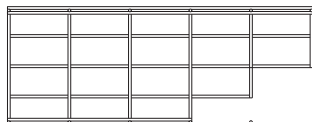

LEVEL DIFFERENCES

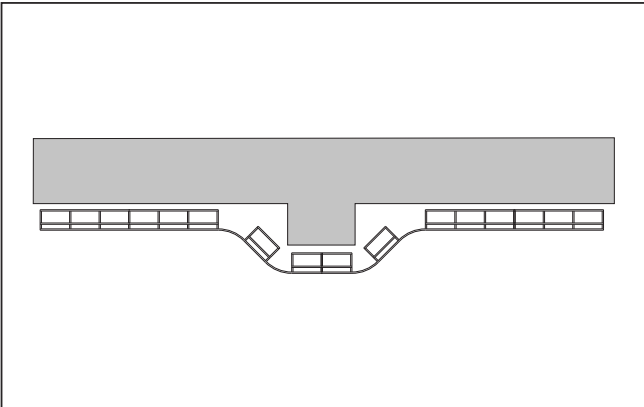

Any level difference can be obtained by cutting away the corresponding zone and bending the cable basket at that spot, until the required shape has been reached.
 For extra reinforcement, the use of the connection plate V35*200 is being recommended.

Cutting and bending

